

THIS DRAWING AND THE DATA DISCLOSED HEREIN OR HEREWITH IS NOT TO BE REPRODUCED USED OR DISCLOSED IN WHOLE OR IN PART TO ANYONE WITHOUT THE PERMISSION OF JPC connectivity Inc.(JPC)

CUSTOMER DRAWING
DRWC-00****

REV.	ECN NO.	DESCRIPTION	MDF'D	APP'D	DATE
A1	---	INITIAL DESIGN	Pefer	Pefer	07/02/2020

NUMBER OF CORES	WIDTH	TP	ERROR (mm)
20	12.70	12.065	±0.10

$$S(\text{Eccentricity}) = |a-b| / 2 < 0.05$$

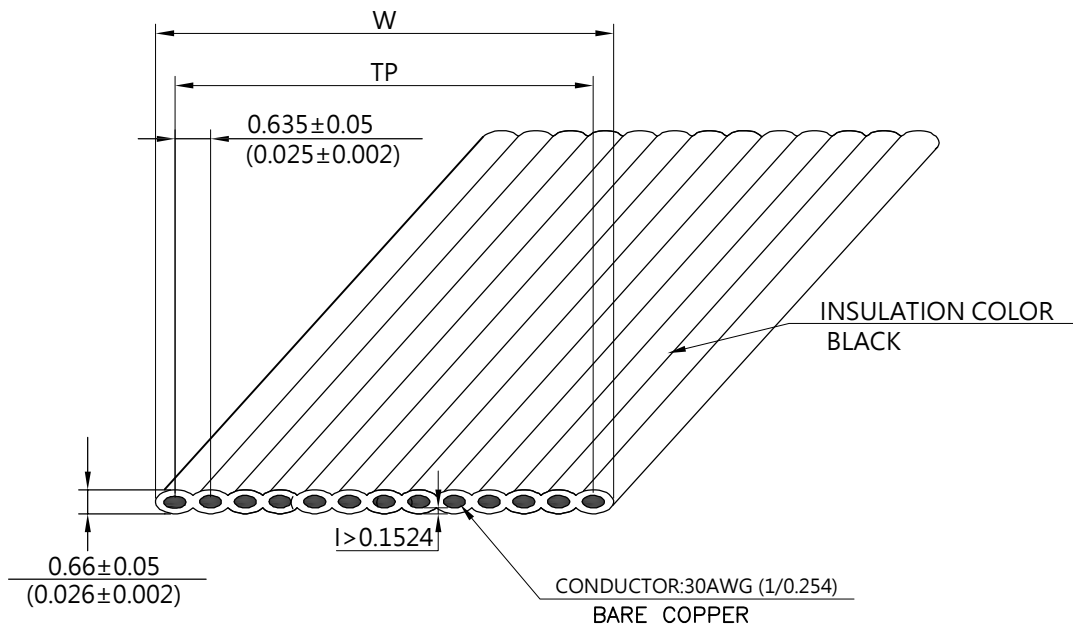
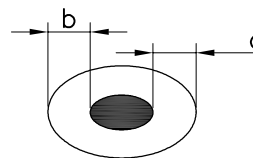

一. SPECIFICATIONS:

UL GRADE:
UL Style..... 2678
Rate Temperature..... -20°c To105°c
Rate Voltage..... 150V
Flame Test..... VW-1

二. PHYSICAL PROPERTY:

Stranded conductor
AWG size.. .. 30 AWG
Material of insulation.. .. PVC Black
Insulation thickness average.. .. 6 mils

三. ELECTRONIC CHARACTERISTICS:

Spark test.. .. 1500V
Dielectric strength test.. .. 1500V in 1 minute
Conductor resistance.. .. MAX 361Ω/km
Insulation resistance.. .. Min 250MΩ/10FT

ITEM	SUPL	SUPL PN	DESCRIPTION	Q'TY
1				
2				
3				
4				
5				

RoHS COMPLIANT

Unit : mm	PROJECTION
GENERAL TOLERANCES: (UNLESS SPECIFIED) 0 = ±1(0.039) 0.0 = ±.5(0.02) 0.00 = ±.3(0.012) 0.000 = ±.15(0.006) 0° = ± 2° 0.0° = ± 1°	D.R. 07/02/2020 Pefer CH.K APV.D

JPC connectivity		
TITLE HMRB series 30AWG P=0.635		PD./FILE NO. XXXXXXXXXX
SCALE NA	SIZE A4	REV. A1
PART NO. PCB124020802-1		SHEET 1 OF 1